



&BEYOND

## LAKE MANYARA TREE LODGE

### *Family Suite*



## TANZANIA



## FAMILY TRAVEL

Set in the heart of a mahogany forest, &Beyond Lake Manyara Tree Lodge is the only permanent lodge in the park of the same name. Here, families can reconnect on a series of unforgettable wildlife experiences, set in the diverse habitats of the Lake Manyara National Park. After a fun-filled day of adventures, guests can retreat to the spacious haven of the lodge's beautiful Family Suite.

Crafted from local timber and makuti palm fronds, the Family Suite is cradled in the boughs of ancient trees. It boasts two classically elegant ensuite rooms, connected by an entrance hall. A generous deck suspends above the forest floor and large windows invite the lush forest inside. The main bathroom boasts a freestanding bath and an outdoor shower, whilst the second bathroom features a shower. The Family Suite can accommodate two adults and two children (three children can be accommodated on special request).

## WILDCHILD CHILDREN'S PROGRAMME

As with all of our lodges, your children will have the opportunity to embark on our very exciting WILDChild programme, which is filled with fun, interactive activities that offer opportunities to learn and discover new experiences and cultures at our lodges across Africa. Adventures at &Beyond Lake Manyara Tree Lodge include butterfly walks, cycling through a village, bow and arrow shooting, spear throwing, making a fire the Maasai way, playing soccer with the staff, baking cookies with the chefs and roasting marshmallows on a fire in the boma.

FAMILY SUITE CONFIGURATION	OCCUPANCY
1 family suite (consisting of 2 ensuite rooms).	2 adults and 2 children (3 children on special request).

*“Get your children travelling early.  
Expose them to the people, the food and the  
real culture of your destination,”*

Joss Kent, &Beyond CEO

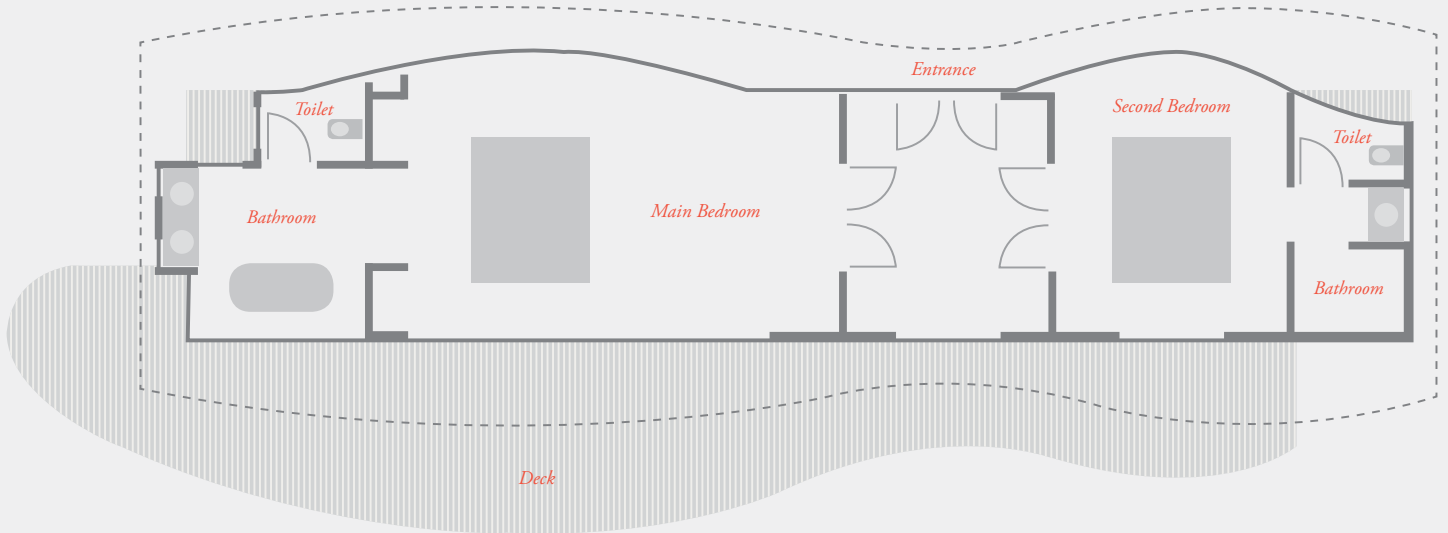

### GAME DRIVE POLICY AT &BEYOND LAKE MANYARA TREE LODGE

The below policy applies to children participating on game drives when staying at the Family Suite.

AGE OF CHILD	SAFARI PARTICIPATION
0 – 2 years	<ul style="list-style-type: none"> <li>Not permitted on game drives, walks outside of the lodge grounds or walking safaris</li> </ul>
3 – 5 years	<ul style="list-style-type: none"> <li>Not permitted on game drives, walks outside of the lodge grounds or Walking Safaris</li> <li>Shortened game drives at discretion of lodge manager</li> </ul>
6 – 11 years	<ul style="list-style-type: none"> <li>Game drives at the discretion of the lodge manager</li> <li>No walks outside of the lodge grounds or Walking Safaris</li> </ul>
12 – 16 years	<ul style="list-style-type: none"> <li>Permitted on game drives and nature walks</li> <li>Not permitted on Walking Safaris</li> </ul>
All ages	<ul style="list-style-type: none"> <li>By booking a private vehicle at &amp;Beyond Lake Manyara Tree Lodge, children can enjoy a game drive that will be tailored to suit their age - subject to availability and at an additional cost.</li> </ul>

Please note that, due to the fact that the lodge is not fenced off, children are required to have an adult accompanying them at all times.

[www.andBeyond.com](http://www.andBeyond.com)

[blog.andBeyond.com](http://blog.andBeyond.com)

[facebook.com/andBeyondTravel](https://facebook.com/andBeyondTravel)

[twitter.com/andBeyondTravel](https://twitter.com/andBeyondTravel)

[instagram.com/andBeyondTravel](https://instagram.com/andBeyondTravel)

[youtube.com/andBeyondTravel](https://youtube.com/andBeyondTravel)

[www.rhinoswithoutborders.com](http://www.rhinoswithoutborders.com)

