

Africa



&BEYOND

PHINDA HOMESTEAD

Phinda Private Game Reserve



SOUTH AFRICA

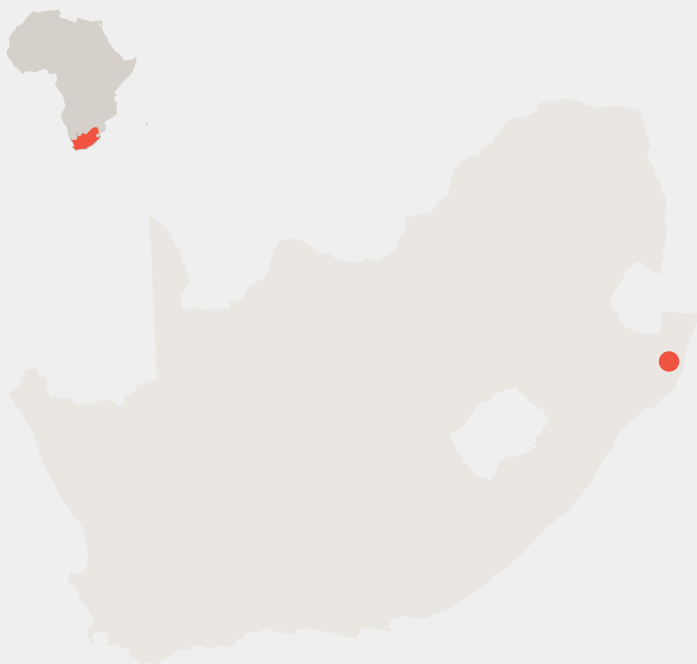

&Beyond Phinda Private Game Reserve encompasses an impressive 28 555 hectares (70 560 acres) of protected wildlife land in KwaZulu-Natal, South Africa. Showcasing one of the continent's finest game viewing experiences, **&Beyond** Phinda is home to Africa's Big Five (lion, leopard, elephant, buffalo and rhino), as well as 436 bird species. The reserve is particularly well known for close-up sightings of the elegant yet elusive cheetah, as well as the rare black rhino.

With its seven distinct habitats, Phinda is often described as 'Seven Worlds of Wonder', a magnificent tapestry of woodland, grassland, wetland and forest, interspersed with mountain ranges, rivers, marshes and pans. Home to 1 000 hectares of Africa's remaining rare dry sand forest, the reserve is situated in close proximity to the unspoiled beaches and spectacular coral reefs of the Indian Ocean, offering an unmatched combination of bush and beach adventures.

Guests at Phinda experience unforgettable interpretive game drives in open 4x4 safari vehicles, led by professionally trained **&Beyond** rangers and Zulu trackers, as well as a wide range of optional adventures in the bush and on the beach.

Phinda is home to six magnificent lodges, each with its own individual charm and character: Mountain Lodge, Rock Lodge, Phinda Homestead, Vlei Lodge, Zuka Lodge and Forest Lodge.



Tucked into the edge of a dappled forest, in the north of the reserve, &Beyond Phinda Homestead is a gracious sole-use safari villa. Blending seamlessly into the natural surroundings, blurring the boundaries between the guest and the bush, the lodge's living areas consist of open spaces, flat-roofed walkways, and shaded areas opening out onto sun decks and a sparkling swimming pool. Designed like a contemporary bush farmhouse, &Beyond Phinda Homestead is both elegant and homely. Inspired by the breathtaking landscape and the local Zulu culture, shaded, flat-roofed walkways flow into open decks, while basketwork, pottery, carpets and textiles are celebrated interior elements. Quirky design touches, like the pineapple motifs, pay homage to the history of the land, before being reclaimed and transformed into a renowned Big Five game reserve. Private bedrooms and spacious bathrooms blend seamlessly into cool, expansive, and inviting guest spaces. An interactive kitchen brings the lodge's private chef into the centre of the guest experience. This much-loved lodge comes with a dedicated ranger and tracker team, as well as a private safari vehicle. Game drives times, as well as meals, are tailored completely to the guests' preference to create a fully personalised safari.

AT A GLANCE

- 4 bedroom air conditioned safari villa
- Sole-use for groups or families
- Extra children's room available at additional cost
- Outdoor showers
- Private open 4x4 safari vehicle
- Dedicated ranger/host, tracker, butler & chef
- Tailormade adventures

{Phinda Homestead}

- Interactive kitchen
- Rim-flow swimming pool
- State-of-the-art exercise room
- A dedicated massage sala

WHAT SETS US APART

- Sole-use safari villa for families or groups
- Private open 4x4 safari vehicle at your convenience
- Dedicated ranger/host, tracker, butler and chef
- Private mini gym, including state-of-the-art exercise equipment
- Children's room available
- Completely customisable daily schedule
- Ideal for families
- Seven habitats allow for much greater diversity in species and landscapes
- Wildlife includes cheetah, black rhino and nyala
- Variety of adventures available
- 28 555-hectare (70 560-acre) private game reserve, with limited vehicle access

ACTIVITIES

Included

- Twice-daily game drives, including afternoon / evening drives
- Guided bush walks

At an additional charge

- Phinda Adventures include Zulu village tours, Maputaland beach adventures, night turtle drives (seasonal), scuba safaris, an ocean safari, black rhino tracking on foot, sleepout under the skies
- Specialist Safaris / Special interest safaris including birding, photographic, rhino notching and game tracking
- Childminder services
- In-room massage



GUEST SAFETY

The lodge is not fenced off and we request guests be extremely vigilant at all times.

ACCESS

- Airlink offer daily scheduled flights from Johannesburg to &Beyond Phinda Private Game Reserve
- Connect &Beyond Phinda Private Game Reserve to: Johannesburg, Cape Town, &Beyond Ngala Private Game Reserve, &Beyond Kirkman's Kamp, northern Sabi Sand Game Reserve, Londolozi, Ulusaba, Vilanculos and Livingstone. All flights route through either Nelspruit or Skukuza
- 7-hour drive from Johannesburg on good roads in a two-wheel drive vehicle
- 3 ½ hour drive from Durban on good roads in a two-wheel drive vehicle
- Private charters from anywhere in South Africa can be arranged to &Beyond Phinda Private Game Reserve's airstrip

ACCOLADES



AUGUST 2018: &BEYOND PHINDA PRIVATE GAME RESERVE IS LISTED THIRD IN THE CONSERVATION PRACTITIONERS CATEGORY AT THE 2018 RHINO CONSERVATION AWARDS



OCTOBER 2017: &BEYOND PHINDA PRIVATE GAME RESERVE LISTED AMONG THE BEST RESORTS IN THE WORLD AT THE CONDÉ NAST TRAVELER 2017 READER'S CHOICE AWARDS



OCTOBER 2017: &BEYOND PHINDA PRIVATE GAME RESERVE FEATURED IN THE TOP RESORTS IN AFRICA CATEGORY IN THE CONDÉ NAST TRAVELER 2017 READER'S CHOICE AWARDS



OCTOBER 2016: &BEYOND PHINDA PRIVATE GAME RESERVE LISTED IN THE CONDÉ NAST TRAVELER (US) TOP RESORTS IN AFRICA: READERS' CHOICE AWARDS

"Phinda Homestead was so impressive! It was exactly like I hoped it would be in my dreams. We saw all the animals and more and learned about the story of Phinda, the plants, trees, stars... everything. Our grandchildren are six and eight and they also never had enough of the safaris. We were all sad that we had to leave."

- Roger & Jacqueline Leroy, &Beyond guests

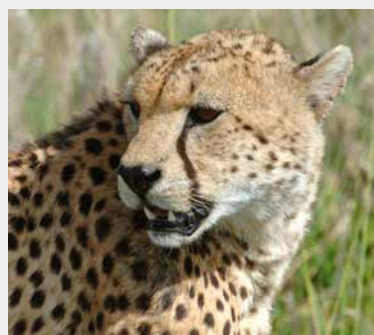

TABLE OF FACTS

NUMBER OF ROOMS	4 ensuite rooms included in villa rate. 1 Children's room available at additional cost
MAXIMUM GUESTS	12 guests max – 8 adults and 4 children (at additional cost). Additional vehicle rate applies for more than 8 guests
CHILDREN'S ROOM	Available and sleeps 4 children (2 bunk beds)
CHILDREN	Yes; no children under 16 on Walking Safaris
CHILDMINDING	Available at an additional cost
TRIPLES	None
TWIN BEDS	All convert to double beds (except bunk beds)
AIR CONDITIONING	Yes
OVERHEAD FANS	Yes
LODGE POOL	Yes
BATH	Yes
INDOOR AND OUTDOOR SHOWERS	Yes (outdoor showers in the four ensuite rooms)
SEPARATE W.C.	Yes
IN-ROOM SAFE	Yes
TELEPHONE	Yes
HAIRDRYER	Yes
LAUNDRY INCLUDED	Yes
WHEELCHAIR ACCESS	Yes, with assistance
CHECK IN / CHECK OUT	14h00 / 11h00
KOSHER FOOD	Available at an additional cost and with at least 4 weeks notice
POWER	220v AC
INTERNET ACCESS	Yes, wifi throughout
CREDIT CARDS	Visa, Diners, Amex, MasterCard

IN-ROOM MASSAGE	Yes
EXERCISE EQUIPMENT	Exercise room with treadmill, yoga mats, exercise ball and static weights
WEATHER	Subtropical climate with hot, humid and wet and summers from September to April and warm to cool and dry winters from May to August
RAINFALL	Rainfall averages 1 000mm / 39" per annum. Much of the rainfall comes in the form of short, intense afternoon thundershowers. Rain can be expected throughout the year
TEMPERATURE	Summer: daytime temperatures above 35°C / 95°F Winter: night-time temperature rarely drops below 10°C / 50°F
BEST TIME TO TRAVEL	All year round; best game viewing from March to end of September
MALARIA	The reserve is situated in a low-risk malaria area
AIRSTRIP	The Phinda airstrip is not registered; coordinates are 27° 46' 65.7" S and 32° 20' 94.2" E
GPS COORDINATES	27° 46' 65.7" S and 32° 20' 94.2" E
LODGE CLOSURE	Open year round

NOTE

- Please note that park fees and government charges may apply. Speak to your travel consultant for more details.
- Drones are not permitted at &Beyond reserves, lodges, camps and villas.

CAMP LAYOUT

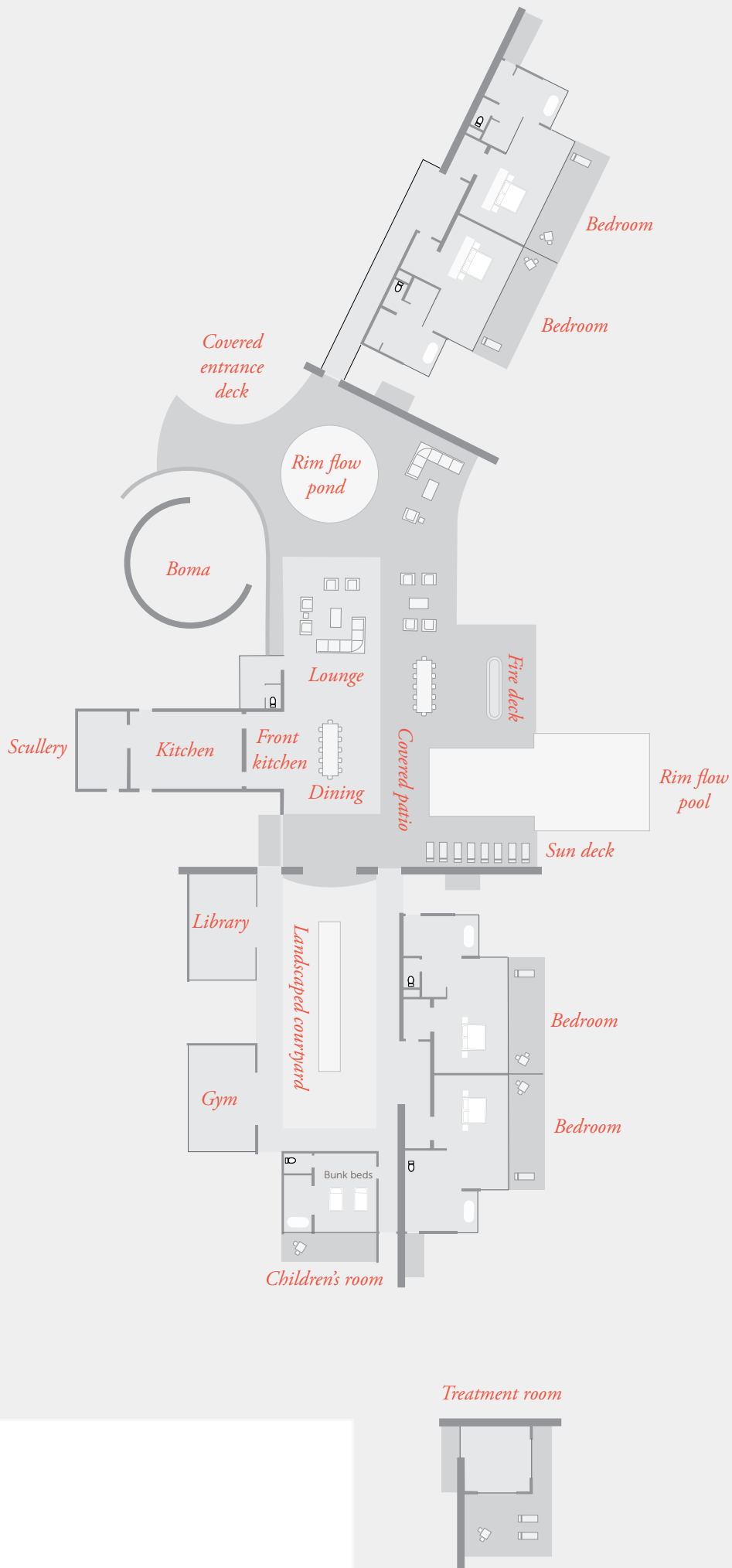

CONTACT